

27/c

AREA STATEMENT

TOTAL AREA OF THE SCHEME 10.43 Hec
SCHEME BOUNDARY

DISTRIBUTION OF AREA

- HOMEOPATHIC MEDICAL COLLEGE / HOSPITAL = 6.08 Hec
- ENGG. COLLEGE (2 Nos x 2.00 HA) = 2.40 Hec
- COLLEGE = 0.81 Hec
- P&EP = 0.80 Hec
- SHOPPING = 0.35 Hec

NOTE -
1. MODIFIED LAY OUT PLAN HAS BEEN APPROVED BY COMM. (PLG.) ON 3.2.2003 AT PAGE 15 IN FILE NO. F15 (L1) 2003 / NP.
2. BEFORE HANDING OF POSSESSION LAND DEPTT. SHALL ENSURE THE LAND OWNERSHIP & AVAILABILITY OF INFRASTRUCTURAL SERVICES FROM THE STATE DEPTT. (INDIAN TOWNS)

AREA OF PSP PROPOSED FOR HOSTEL (2 Nos) = 0.40 HA
CCF (P&EP) = 0.40 HA

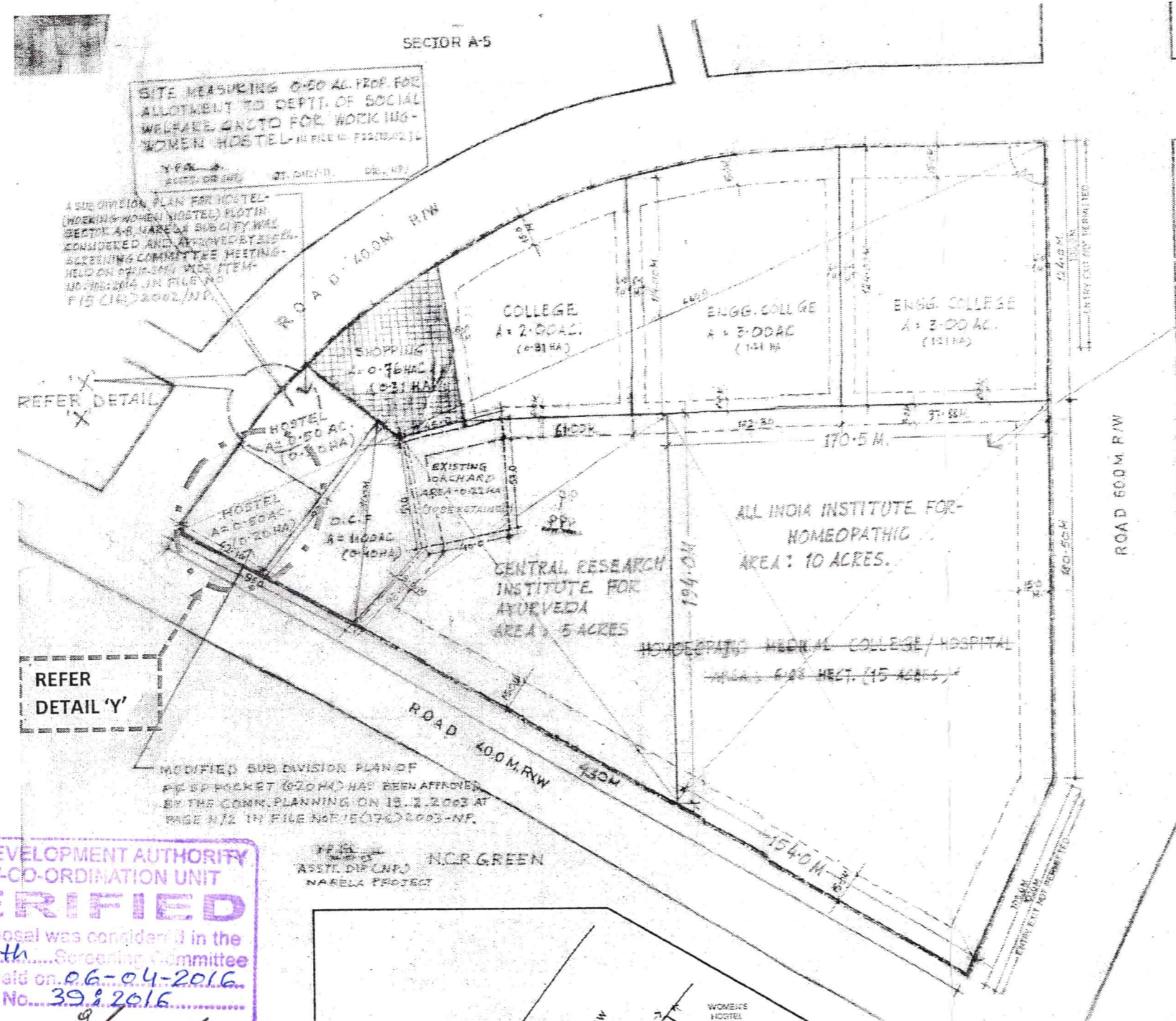

THE PLOT earmarked for HOMEOPATHIC MEDICAL COLLEGE / HOSPITAL MEASURING 6.08 HA. (15 ACRES) IS PROPOSED FOR SUBDIVISION AS UNDER:-
I) ALL INDIA INSTITUTE FOR HOMEOPATHIC - 10 ACRES
II) CENTRAL RESEARCH INSTITUTE FOR AYURVEDA-05A.
THE ABOVE PROPOSAL WAS CONSIDERED AND APPROVED IN 327th SCREENING COMMITTEE HELD ON 19.12.2014, VIDE ITEM NO. 159: 2014.

THE AGENDA AND MINUTES ARE AUTHENTICATED WITH APPROVED DRAWINGS VERIFIED BY DY. DIR. ARCH. (CO-ORDN.) IN FILE NO. F15(16)2003/ NP AT PAGE 145/1 TO 149/1 AND AT PAGE 25/1.

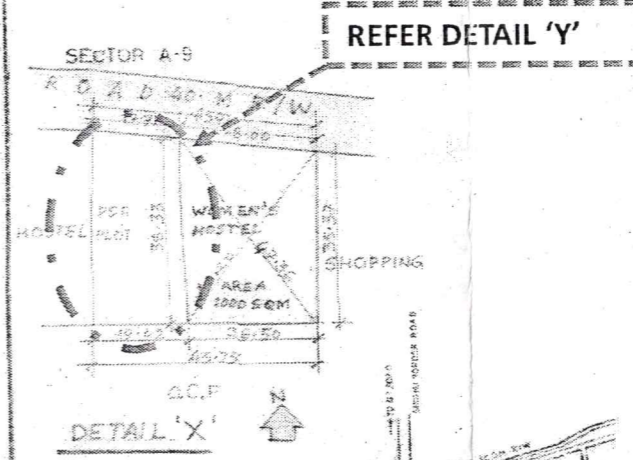

DELHI DEVELOPMENT AUTHORITY
HUPW-CO-ORDINATION UNIT
VERIFIED
This proposal was considered in the 338th Screening Committee Meeting held on 06-04-2016. Vide item No. 39: 2016.
Dy. Director (Arch.) Co-ordn.

FILE NO. NCR GREEN
ASSTT. DIR. (PLG.)
NARELA PROJECT

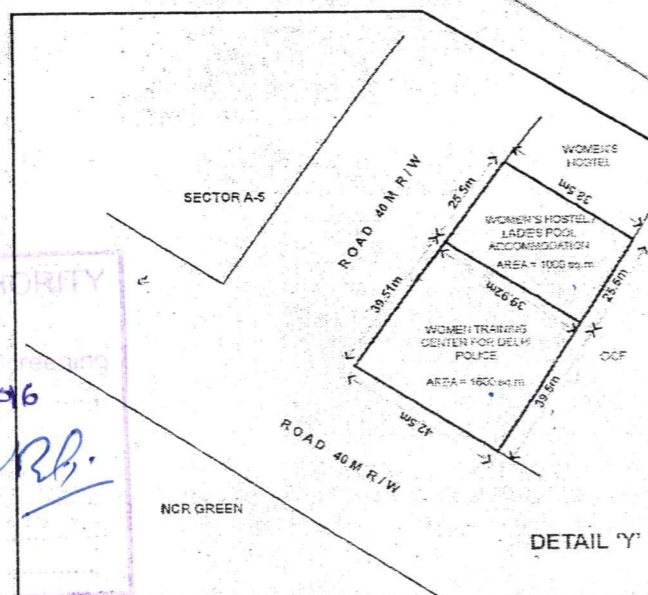

NOTE:-
THE PROPOSAL OF MODIFICATION OF LAYOUT PLAN OF SECTOR A-8, PSP AREA NARELA FOR WOMEN'S HOSTEL / LADIES POOL ACCOMMODATION AND WOMEN TRAINING CENTER FOR DELHI POLICE, ARE CONSIDERED IN THE 338th SCREENING COMMITTEE MEETING HELD ON 06-04-2016 VIDE TIEM No.- 39 : 2016, AND BOTH ARE APPROVED.

PLG. ASSTT. ASSTT. DIR. (PLG.) DY. DIR. (PLG.) DIRECTOR (PLG.)

MODIFIED LAY OUT PLAN
LAYOUT PLAN SECTOR A-8
PSP AREA NARELA PH/II
1000